

THE INFORMATION CONTAINED IN THIS DRAWING IS THE SOLE PROPERTY OF GREENFIELD MFG CO ANY REPRODUCTION IN PART OR WHOLE WITHOUT THE WRITTEN PERMISSION OF GREENFIELD MFG CO IS PROHIBITED.

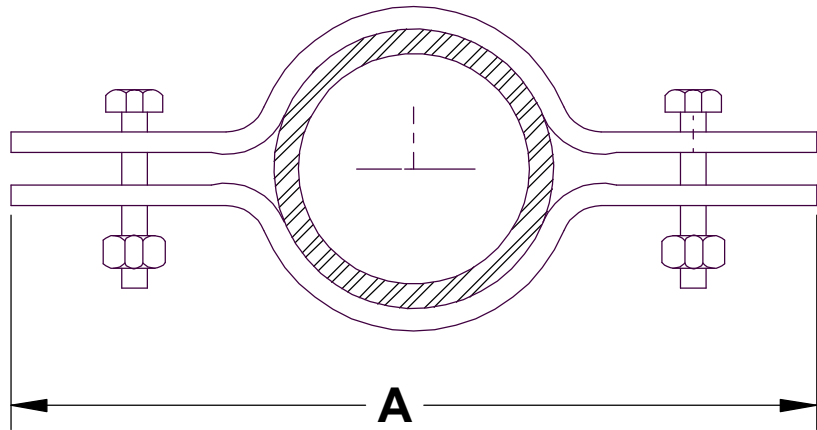

SIZE	A	STOCK	BOLT	MAX REC LOAD
1/2	8.63	1/8 X 1.00	5/16 X 1.00	220
3/4	8.82	1/8 X 1.00	5/16 X 1.00	220
1	9.06	1/8 X 1.00	5/16 X 1.00	220
1-1/4	9.50	1/8 X 1.00	5/16 X 1.25	250
1-1/2	10.00	5/32 X 1.00	5/16 X 1.25	250
2	10.50	5/32 X 1.00	3/8 X 1.50	300
2-1/2	11.12	1/4 X 1.00	3/8 X 1.50	400
3	11.50	1/4 X 1.00	3/8 X 1.75	500
4	13.00	1/4 X 1.00	7/16 X 1.50	600
5	14.00	1/4 X 1.25	1/2 X 2.00	1200
6	15.00	1/4 X 1.50	1/2 X 2.00	1600
8	18.50	3/8 X 1.50	5/8 X 2.50	2500
10	21.00	3/8 X 2.00	5/8 X 2.50	2500
12	23.00	1/2 X 2.00	5/8 X 2.50	2700

Made in USA

UNLESS OTHERWISE SPECIFIED
DIMENSIONS ARE IN INCHES
TOLERANCES ARE:
FRACTIONS DECIMALS ANGLES
+/- 1/8 .XX +/- .03 .XX + 1
 .XXX +/- .01

MATERIAL
CQ STEEL ZINC COATED

DO NOT SCALE DRAWING

CAD GENERATED DRAWING,
DO NOT MANUALLY UPDATE

APPROVALS	DATE
DRAWN EG	
CHECKED SB	

3/12

GREENFIELD MFG CO
9800 BUSTLETON AVE, PHILA., PA 19115

P/N **RISER CLAMP**

A **FIG 308**

REV.

SCALE CAD FILE: SHEET OF