

THE INFORMATION CONTAINED IN THIS DRAWING IS THE SOLE PROPERTY OF GREENFIELD MFG CO ANY REPRODUCTION IN PART OR WHOLE WITHOUT THE WRITTEN PERMISSION OF GREENFIELD MFG CO IS PROHIBITED.

1/2" -2 " made in USA

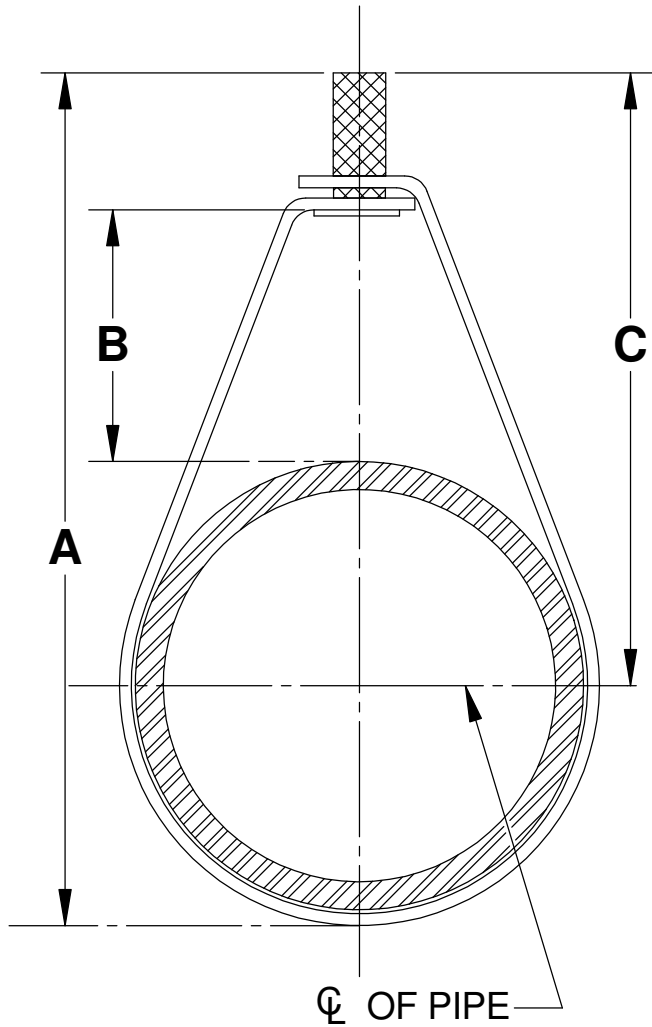

**NOTE:
EPOXIE / COPPER COATED**

PIPE SIZE	MATERIAL SIZE	ROD SIZE	DRAWING REF			WT. PER 100	MAX REC. LOAD
			A	B	C		
1/2"	19ga x 1	3/8"	3"	1 - 1/8"	1 - 1/2"	8	400
3/4"	19ga x 1	3/8"	3 - 1/8"	1 - 1/8"	1 - 3/4"	9	400
1"	19ga x 1	3/8"	3 - 3/8"	1 - 1/8"	1 - 7/8"	10	400
1 - 1/4"	19ga x 1	3/8"	3 - 3/4"	1 - 1/8"	2 - 1/8"	11	400
1 - 1/2"	19ga x 1	3/8"	4"	1 - 1/8"	2 - 1/4"	13	400
2"	19ga x 1	3/8"	4 - 5/8"	1 - 1/8"	2 - 1/2"	14	400
2 - 1/2"	16ga x 1	3/8"	5 - 1/2"	1 - 3/8"	3 - 1/8"	30	600
3"	16ga x 1	3/8"	6 - 3/8"	1 - 5/8"	3 - 5/8"	32	600
4"	16ga x 1	3/8"	7 - 1/2"	1 - 5/8"	4 - 1/8"	44	1000

UNLESS OTHERWISE SPECIFIED
DIMENSIONS ARE IN INCHES
TOLERANCES ARE:
FRACTIONS DECIMALS ANGLES
+ .XX+ .XX + 1
.XXX+.XXX

CAD GENERATED DRAWING,
DO NOT MANUALLY UPDATE

APPROVALS	DATE
DRAWN EG	
CHECKED SB	

GREENFIELD MFG CO

**9800 BUSTLETON AVE.
PHILADELPHIA.,PA. 19115**

P/N **FIG 301**

A **ADJ. SWIVEL CT** REV.

MATERIAL **STEEL**

FINISH **SEE-NOTE**

DO NOT SCALE DRAWING

8/24

SCALE

CAD FILE

301.SLDRW

SHEET OF