

THE INFORMATION CONTAINED IN THIS DRAWING IS THE SOLE PROPERTY OF GREENFIELD MFG CO ANY REPRODUCTION IN PART OR WHOLE WITHOUT THE WRITTEN PERMISSION OF GREENFIELD MFG CO IS PROHIBITED.

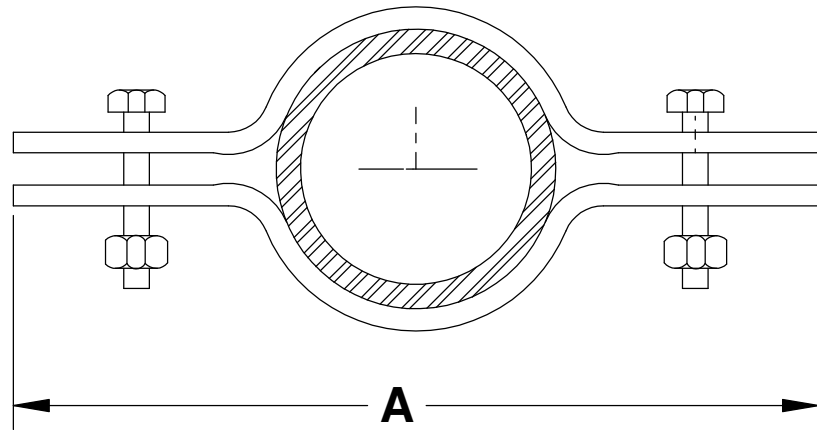

| SIZE | A | STOCK | BOLT | MAX REC LOAD |
|-------|-------|-------------|-------------|--------------|
| 1/2 | 8.63 | 1/8 X 1.00 | 5/16 X 1.00 | 220 |
| 3/4 | 8.82 | 1/8 X 1.00 | 5/16 X 1.00 | 220 |
| 1 | 9.06 | 1/8 X 1.00 | 5/16 X 1.00 | 220 |
| 1-1/4 | 9.50 | 1/8 X 1.00 | 5/16 X 1.25 | 250 |
| 1-1/2 | 10.00 | 5/32 X 1.00 | 5/16 X 1.25 | 250 |
| 2 | 10.50 | 5/32 X 1.00 | 3/8 X 1.50 | 300 |
| 2-1/2 | 11.12 | 1/4 X 1.00 | 3/8 X 1.50 | 400 |
| 3 | 11.50 | 1/4 X 1.00 | 3/8 X 1.75 | 500 |
| 4 | 13.00 | 1/4 X 1.00 | 7/16 X 1.50 | 600 |
| 5 | 14.00 | 1/4 X 1.25 | 1/2 X 2.00 | 1200 |
| 6 | 15.00 | 1/4 X 1.50 | 1/2 X 2.00 | 1600 |
| 8 | 18.50 | 3/8 X 1.50 | 5/8 X 2.50 | 2500 |
| 10 | 21.00 | 3/8 X 2.00 | 5/8 X 2.50 | 2500 |
| 12 | 23.00 | 1/2 X 2.00 | 5/8 X 2.50 | 2700 |

Complies with MSS-SP-58 Type 8

1/2" - 6" Made in USA

UNLESS OTHERWISE SPECIFIED
DIMENSIONS ARE IN INCHES
TOLERANCES ARE:
FRACTIONS DECIMALS ANGLES
+/- 1/8 .XX +/- .03 .XX + 1
 .XXX +/- .01

MATERIAL
CQ STEEL

DO NOT SCALE DRAWING

CAD GENERATED DRAWING,
DO NOT MANUALLY UPDATE

| | |
|------------|------|
| APPROVALS | DATE |
| DRAWN EG | |
| CHECKED SB | |

8/23

GREENFIELD MFG CO
9800 BUSTLETON AVE.
PHILADELPHIA, PA. 19115

P/N **RISER CLAMP**

A **FIG 108**

REV.

SCALE

CAD FILE:

SHEET OF